



Protection devices for scroll and reciprocating compressors

SE-B1/SE-B2

Temperature monitoring

The SE-B1/SE-B2 opens the relay contact in the control circuit and locks out immediately if the allowable temperatures for motor or discharge gas (optional PTC sensor) are exceeded.

Reset

Interrupt supply voltage (L/N) for at least 5 seconds.



All Bitzer reciprocating and scroll compressors of the ESH7 and ESH9 series have as standard equipment the motor protection devices SE-B1 or SE-B2 (Signal Evaluation - Basic).



SE-B1/SE-B2 connection diagram

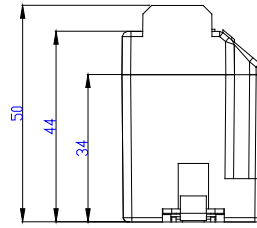
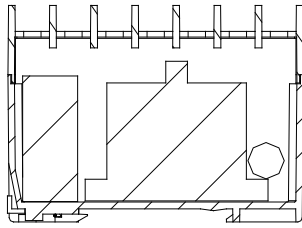

SECTION B-B

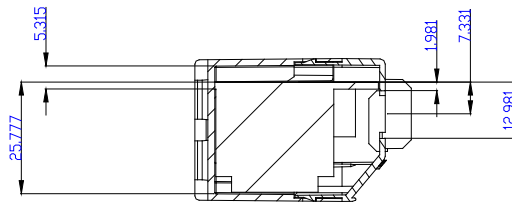
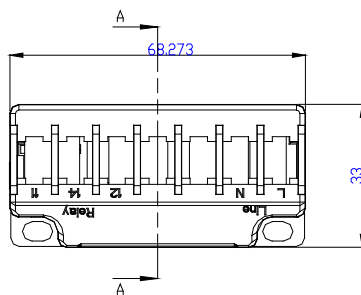

Technical specifications:

Operation voltage 230V; +10% ~ -15%, 50/60 Hz
(other voltages upon request)

Permitted ambient temperature -30°C ~ +70°C

Relay Switch voltage 250V ~
Continuous current max. 2.5A
Switching capacity 300VA

PTC measuring circuit Sensor type:
Thermistors according to DIN 44081/82,
Thermistor type:
1..9 in series R total < 1,8 KΩ
Switching point:
Relay off > 4,5 KΩ +/- 5%
Relay on > 2,7 KΩ +/- 5%

Fuse required 4 A quick blow

Enclosure class Terminals IP00

Terminals torque rating 6 lb-in / 0.7 Nm

Terminal wire range Cu 60°C only. 20-14 AWG / 0.5 mm² - 2,0 mm²

